

*If you enjoyed this kit, why not try...*



## Nordic Gnomes in a Hoop

Produced by The Crafty Kit Company, 21 High Street, East Linton, East Lothian, United Kingdom EH40 3AA.

Made and designed in the UK.

The kit includes a functional sharp point. May include polyester fibrefill stuffing and small parts which are choking hazards. Please keep these instructions for future reference. Adult supervision required.



[WWW.CRAFTYKITCOMPANY.CO.UK](http://WWW.CRAFTYKITCOMPANY.CO.UK)

BEAUTIFUL CRAFT KITS  
100% GUARANTEED  
Crafting fun!  
TO CREATE OR GIVE



AGE 10+

NEEDLE FELTING KIT

## Hedgehog in a Hoop

*This kit contains everything you need to make this moon-gazing hedgehog in a hoop. Ideal for complete beginners to needle felting.*

## Items you'll need/handy to have:

- Small, sharp scissors or snips
- Large scissors
- A pencil
- Glue (a hot glue gun is ideal)

## Welcome to the wonderful world of painting with wool!

This simple, effective needle felting method is a bit like painting by numbers, using wool instead of paint! After transferring your image onto fabric, you'll add small pieces of wool to build up the colours in the different areas of your image.

You can 'paint with wool' onto almost any textile surface. We like using felt as the fibres of wool easily attach to the wool fibres but you could try linen, canvas, denim or even knitwear!

### A few hints and tips:

- Work with very small pieces of wool. It's much easier to build up colour this way, and easy to remove if you make a mistake.
- Hold your work up to a light source occasionally; this will show up any gaps that you might want to add more wool to.
- For small details and lines, you'll only need a few strands of wool. Roll into a ball for dots or twist the wool to create lines.

- Use a heavier gauge needle to cover large areas and a fine gauge needle to add details and smooth out your work.
- Use the needle to drag the fibres along the edges of your work, tucking them in to create a nice smooth outline.



### Your kit contains:

- 2g Petrol wool
- 2g Raven wool (Black)
- 2g Seafoam wool
- 2g Bubblegum wool (Blue/green blend)
- 2g Bear wool (Brown)
- 2g Lichen wool (Moss green)
- 2g Leaf wool (Light green)
- 2g Fox wool (Rust)
- 2g Fawn wool
- 2g White wool
- 15cm Embroidery hoop
- 14cm x 14cm Hedgehog fabric
- Black felt fabric (24 x 24cm)
- Chalk
- Felting pad
- Felting needles
- Instructions

## INSTRUCTIONS

We're working on a large eco-friendly wool felting mat. The small recycled foam mat that comes with your kit can be used to protect the needle and your work surface.

**1.** Lay out the contents of your kit.

**Pic 1**

**2.** Place the embroidery hoop on top of the felt. Mark the inner edge of the hoop with chalk. **Pics 2a, 2b**

**3.** Cut out the hedgehog body template. If you have access to a photocopier, it's a good idea to copy it first to save your booklet. Place the template on the non-spiky side of the hedgehog fabric. Draw around the template onto the fabric. Cut out the hedgehog body from the fabric. **Pic 3**

**4.** Position the hedgehog body on the black felt square as shown. Draw around the top of the body with chalk. This will act as a guide. **Pics 4a, 4b**

**5.** Now to blend some wool to create the night sky. Select a small amount of each of black and petrol wool – the two colours on the left of Pic 5a. Pinch and pull small pieces of both colours with your fingers to start blending. Continue to mix the two colours until you have a good blend. It doesn't need to be even; in fact, the effect is better when you leave some unblended pieces of wool in the mix. **Pics 5a, 5b**

**6.** Using small pieces of wool, begin to fill the shape of the sky, covering the chalk line at the top and taking the wool right down to the guide line for the hedgehog's back. Try to keep the wool a nice, even thickness. Add a little more black wool to the top edge of the sky. Remember to lift your work off the mat occasionally as it will stick. **Pics 6a, 6b, 6c**

**7.** Take a small pinch of petrol wool. Spread it out thinly. You won't need very much at all; it's always easier to add more than to take it away once it's felted in place! **Pic 7**

**8.** Lay the petrol wool on top of the blended sky, slightly to the left. You're creating the night sky around the moon, so keep this in mind when deciding on the position. **Pic 8**

**9.** Repeat steps 7 and 8 with a small pinch of blue/green blend wool. Felt this over the lightest area of the sky. As the sky gets lighter around the moon, make this area a little smaller than the last step. **Pics 9a, 9b**

**10.** Again, repeat steps 7 and 8 with a very small pinch of seafoam wool. **Pics 10a, 10b**

**11.** Create the moon. Using just a pinch of white wool, form a small disc in your fingers by tucking all the loose strands in. It doesn't need to be a perfect circle. Poke this into place. Use your needle to refine the shape but tucking in loose strands as you felt. **Pics 11a, 11b**



**12.** Glue the hedgehog body into place using either PVA or a fabric glue. Allow to dry. If you prefer, you can use a needle and thread to stitch the body to the felt backing. **Pic 12**

**13.** Add some stars to the night sky by rolling up very small pieces of white wool and poking them into place. The stars don't need to be uniform in size and they look best randomly placed. **Pic 13**

**14.** Using small, thin pieces of brown wool, felt all around the edge of the hedgehog body, covering the join between the hedgehog fabric and the felt backing. You will find the hedgehog fabric a little stiff to poke through. Go slowly and take care; the end of the needle is very fragile. **Pics 14a, 14b**

**15.** Take a pinch of moss green wool. Spread it out thinly. Poke into place under the hedgehog. Try to avoid any harsh edges. You can use your needle to gently pull the wool to spread it out at the edges before poking it into place. **Pics 15a, 15b**

**16.** Add a little more brown wool just under the bottom edge of the hedgehog to create a shadow. **Pic 16**

**17.** Add a few small pieces of light green wool on top of the moss green. **Pic 17**

**18.** Add a few small dots of rust wool and a little more brown wool along the bottom edge of the grass.

You can also add a few blades of grass by twisting small pieces of green wool tightly and poking them into place. You can use sharp scissors to trim the grass if it's too long! **Pics 18a, 18b**

**19.** Take a small pinch of fawn wool. Fold it in half and twist the folded end tightly between your fingers to form a point. Spread out the 'tails' to form a rough triangular shape. **Pics 19a, 19b**

**20.** Poke this into place, covering the edge of the front of the hedgehog's body. You can refine the shape with needle and spread the fibres out evenly. Spend a little time poking the head and snout all over to make it nice and smooth. **Pics 20a, 20b**

**21.** Roll up a very small piece of black wool and poke this into place to create the eye. **Pic 21**

**22.** Add a tiny dot of white to highlight the eye. **Pic 22**

**23.** Repeat steps 21 and 22 to make a black snout. Add a little oval of brown wool to make an ear. Poke a small amount of black wool onto the inside of the ear. **Pic 23**

**24.** Add a very thin, wispy piece of brown wool along the bottom edge of the snout, and some small pieces of black wool to create the suggestion of two legs; one at the front, one in the middle (the other two legs are hidden!) and a stumpy little tail at the back. **Pic 24**

**25.** Separate the two parts of the hoop by almost completely unscrewing the screw at the top. Lay your design over the complete hoop and push the outer hoop over the top. You'll need to spend some time repositioning the design so that it's central in the hoop. The wool on the felt backing makes for quite a thick piece of fabric, so you'll find it's a tight squeeze to push the hoop over the top!

When you're happy with the position of the design, tighten the screw at the top of the hoop. Turn your work over and use sharp scissors to trim away all the extra felt backing from around the hoop. Optionally, you can run a little glue around the edge of the felt to make sure everything stays in place. **Pics 25a, 25b, 25c**

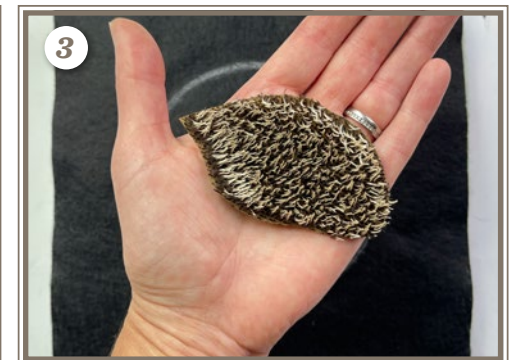



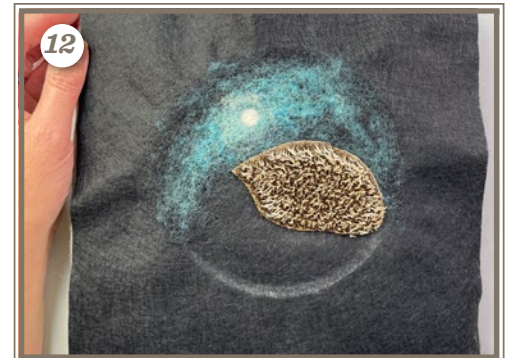
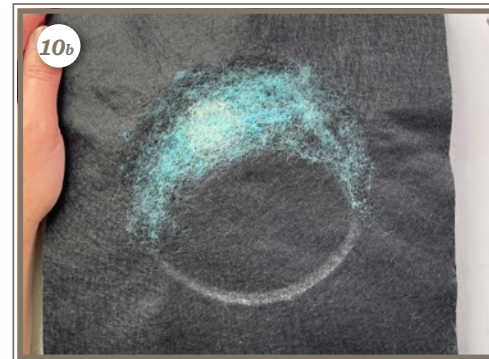
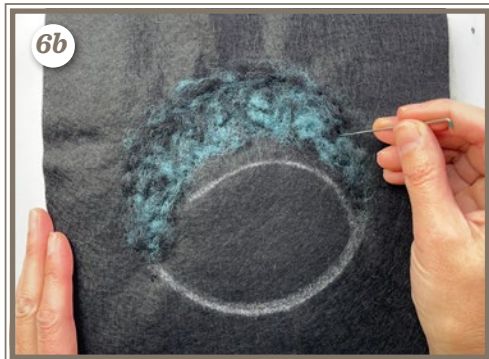
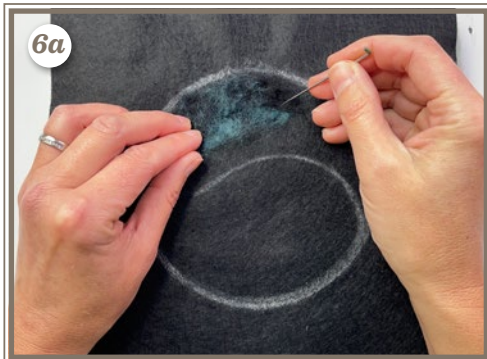
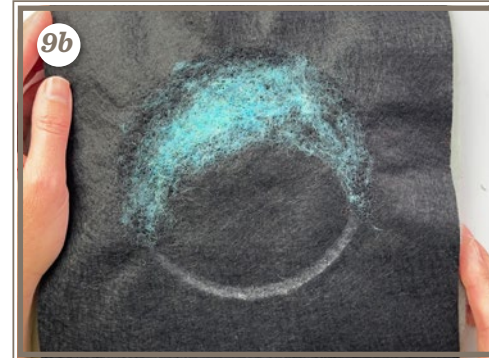
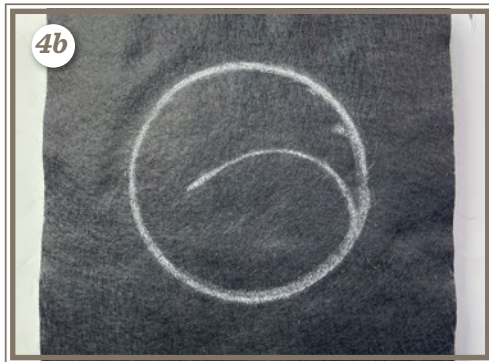
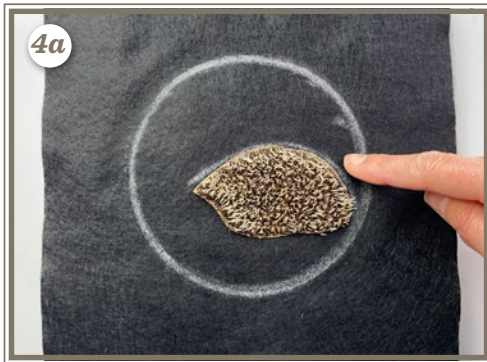







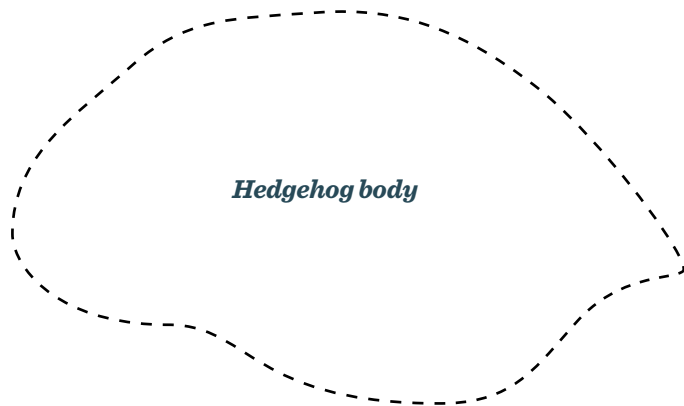

*Hedgehog body*

# GUIDE TO FELTING NEEDLES

Included in your kit are top quality felting needles made in Germany by Groz-Beckert, a specialist needle manufacturer.

Your needles are colour-coded, with a painted crank to help you identify them among your felting supplies!

NEEDLE	BARBS	WEIGHT	DESCRIPTION
TRIANGULAR CROSS 36	6	Heavy	Heavier gauge needles, useful for quickly building up the main body of a project.
TRIANGULAR CROSS 38	6	Medium	Great 'all-round' medium gauge needles, suitable for most felting projects.
TRIANGULAR CROSS 40	6	Fine	Fine gauge needles, suitable for detailed work and finishing.
TWISTED 36	9	Heavy	A twisted, triangular cross-sectional working area with a greater number of barbs, these needles work faster and leave less visible holes.
TWISTED 38	6	Medium	The triangular cross-sectional working area of these needles has been twisted, which works faster and leaves less visible holes.
TWISTED 40	6	Fine	A twisted cross-sectional working area, making these needles ideal for fine and finishing work.
CROSS STAR 36	8	Heavy	Heavier gauge needles, useful for quickly building up the main body of a project. They have more sides and barbs than triangular needles, and felt faster.
CROSS STAR 38	8	Medium	Medium gauge needles, finer than 36 gauge, but still useful for quickly building up the main body of a project.
REVERSE BARB 32	9	Heavy	Heavy-gauge needles which have opposite pointing barbs to regular felting needles and pull fibres outwards instead of felting inwards, creating a fluffy effect.
REVERSE BARB 40	6	Fine	Fine-gauge needles which also have the barbs pointing the opposite direction to regular felting needles and are also used to create a furry or fluffy effect.

## Questions and comments

We treasure you as a customer and your satisfaction with this product is very important to us. If you have any queries or comments, please do not hesitate to get in touch by emailing us at: [info@craftykitcompany.co.uk](mailto:info@craftykitcompany.co.uk) or by calling us in the UK on **+44 01620 860907**